

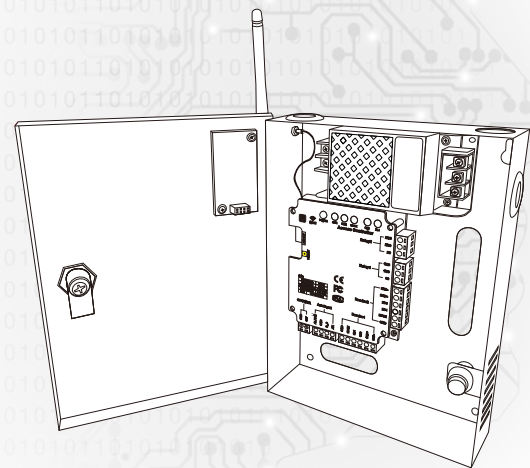

Quick Start Guide



Access control

1 Product Introduction

This product is controlled and set by Tuya APP. It can realize remote open, staff access management, abnormal message prompts, temporary visitors password, etc.

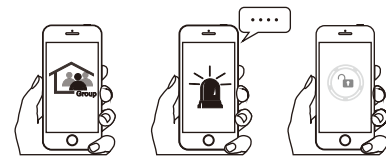

Product Appearance

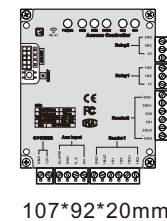
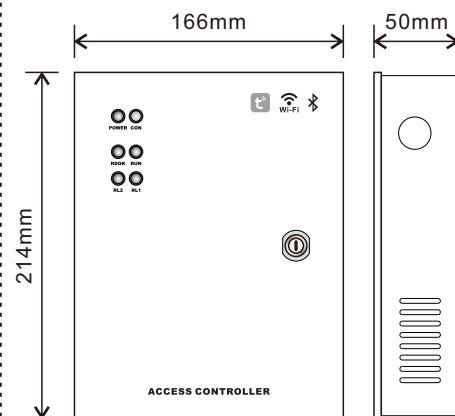

107*92*20mm

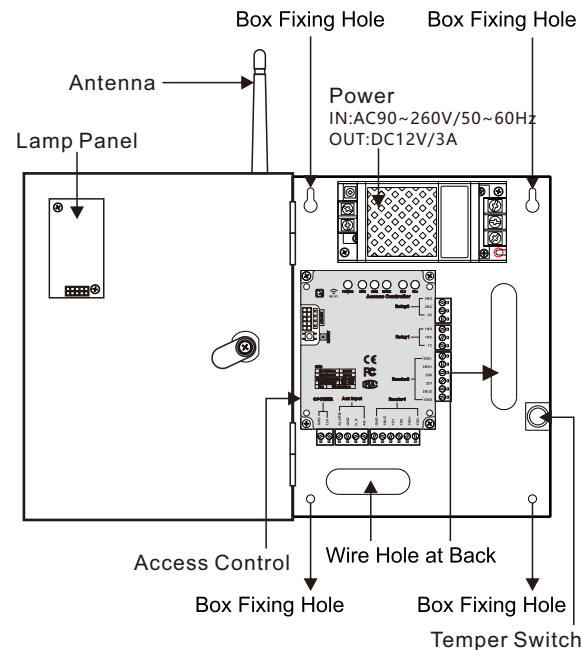

Product Mounting

- 1 Use self-tapping screws to fix the box to the wall through the mounting holes.
- 2 Remove the protective cap and install the antenna on the antenna terminal.
- 3 Open the cable hole for threading.
- 4 Be sure to ground the power supply, otherwise abnormal conditions may occur.

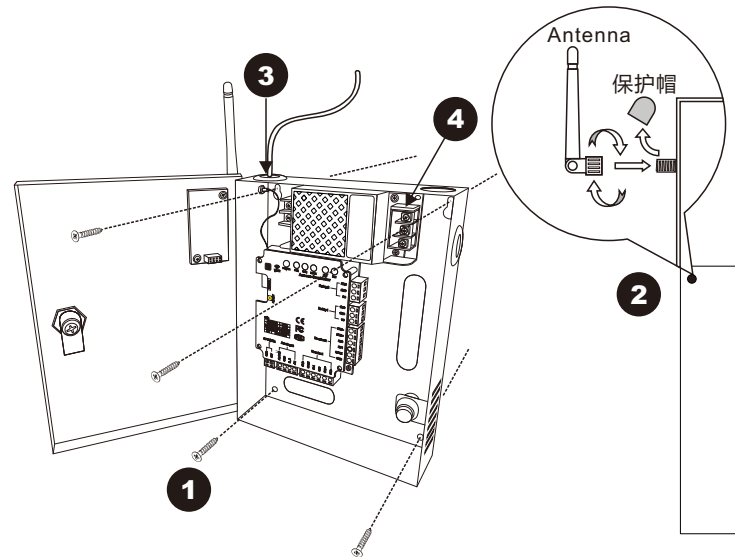

使用准备

- 1 Download and install Tuya APP.
- 2 Turn on the permission of the APP to use bluetooth.
- 3 Open the APP's permission to use the local area network and cellular network.
- 4 Create a family to better manage devices.

Please search for "Smart Life" in the APP store, download and install, or scan the QR code below to download and install directly.



Note: The interface used in this manual is for illustration only, please refer to Tuya APP.

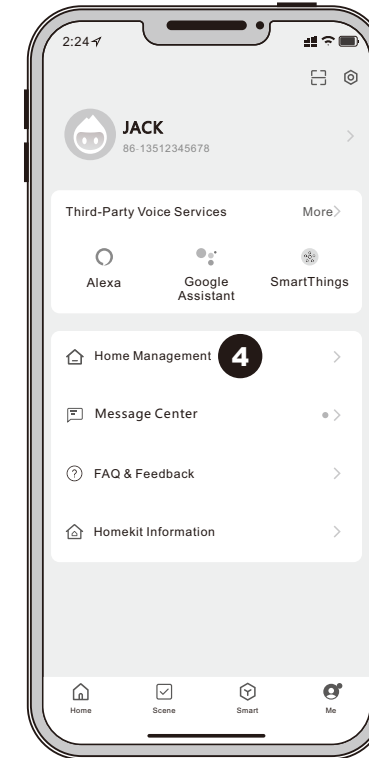

2 Function Parameter

Item	Parameter
Material	ABS, aluminum alloy, toughened Glass
Working Voltage/Current	DC12V±10%/2A(Non-loaded)
Processor	High-performance dual-core ARM chip /ISP/NPU
Communication Mode	WiFi/Bluetooth
Recognition Speed	<0.5s
Users	1000
Verification Type	Card/Password/Card+Password
Temporary Code	10
Password support digits	6Bit
Lock Control Output	1
Alarm Output	1
Temper Switch	1
Exit Button	1
Door Magnet Input	1
Working Environment	-20°C~60°C /10%-90%
IP Grade	IP53
Install Type	Wall
Size	L214XW166XH50mm

Statement

To the maximum extent permitted by law, the products described in this manual (including hardware, software, firmware, etc.) are provided as they are. There may be defects, errors, or malfunctions. This manual is for guidance only. The graphics, icons, and illustrations provided in the manual are for explanation and illustration only. There may be differences with specific products, please refer to the actual product. The company does not provide any form of express or implied guarantee, including but not limited to guarantees of marketability, quality satisfaction, suitability for specific purposes, and non-infringement of third-party rights, nor does it provide any special guarantees caused by the use of this manual or the company's products. Incidental, incidental or indirect damages, including but not limited to loss of business profits, loss of data or documents. If you connect products to the internet, you need to bear your own risks, including but not limited to, the product may suffer from hacker attacks, virus infections, network attacks, data leakage, etc. The company does not assume any major or related responsibility for product failure, abnormality, information leakage and other issues caused by this. However, the company will provide users with product-related technical support. When you use this product, you will collect, store, and use important personal information. As the data controller, when collecting, storing, and using personal information, please follow the relevant laws and regulations applicable to the protection of personal privacy. The company is not responsible for all personal and property losses caused by misuse of personal data. The company's products have encrypted personal biometric information. Its characteristic value cannot be restored to an image. Please observe the laws and regulations of the place of use when using the product. If this product is used to infringe the rights of a third party or other improper purposes, the company will not bear any responsibility. If the content of this manual conflicts with applicable laws, the legal provisions shall prevail.

For More Help

3 Packing List

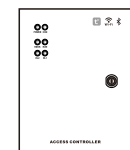

BOX×1



Access Control×1



Power×1

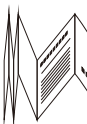

Quick Start Guide×1



Tapping Screw×4

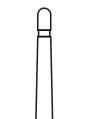

Rubber Stopper×4

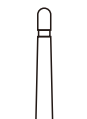

Key×1

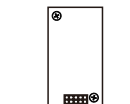

Lamp Panel×1



Light board cable×1

4 The Interface Definition

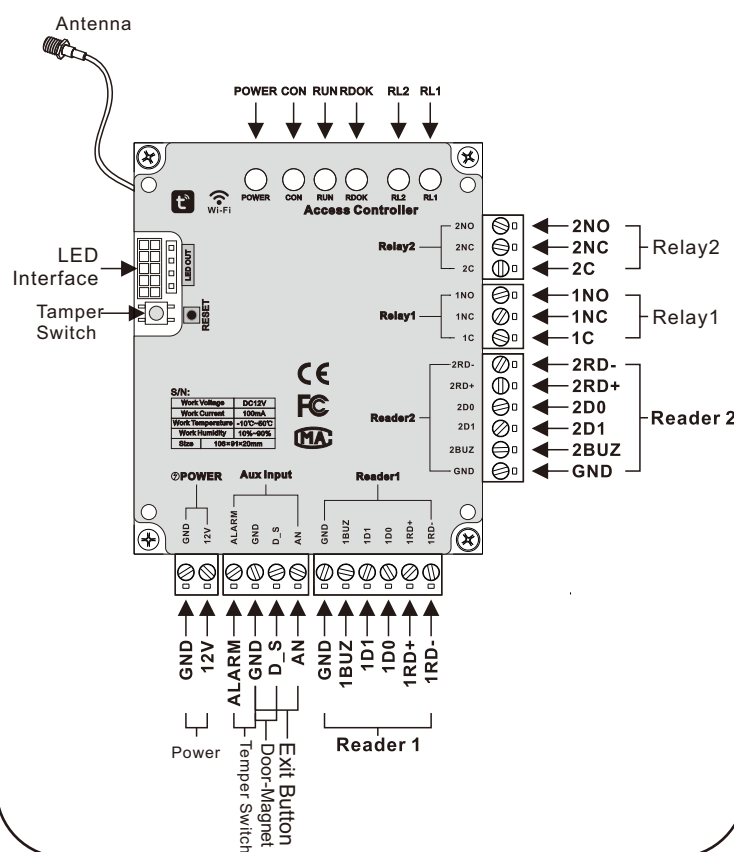

5 Wiring of Access Control Function

Warning:

- Please do not use the power supply that comes with this product to power the lock. It is attendance only.
- Please do not connect the wires when the power is on.
- Please strictly comply with the national and regional electrical safety regulations.
- If you have any problem with the product, please contact the device seller. Do not disassemble or modify this product without permission.

Note:

- Please read this manual carefully before starting the installation.
- The distance from the card reader to the controller should not exceed 60 meters.
- Be sure to install the ground wire of the power supply.
- Avoid damp, strong electromagnetic environment, outdoor bare leakage places.

Sound^①: This function requires the use of a card reader, please connect the BUZ port of the controller to the indicator light and sound controller line of the card reader. The product picture is for reference, if any difference, please refer to the actual product.

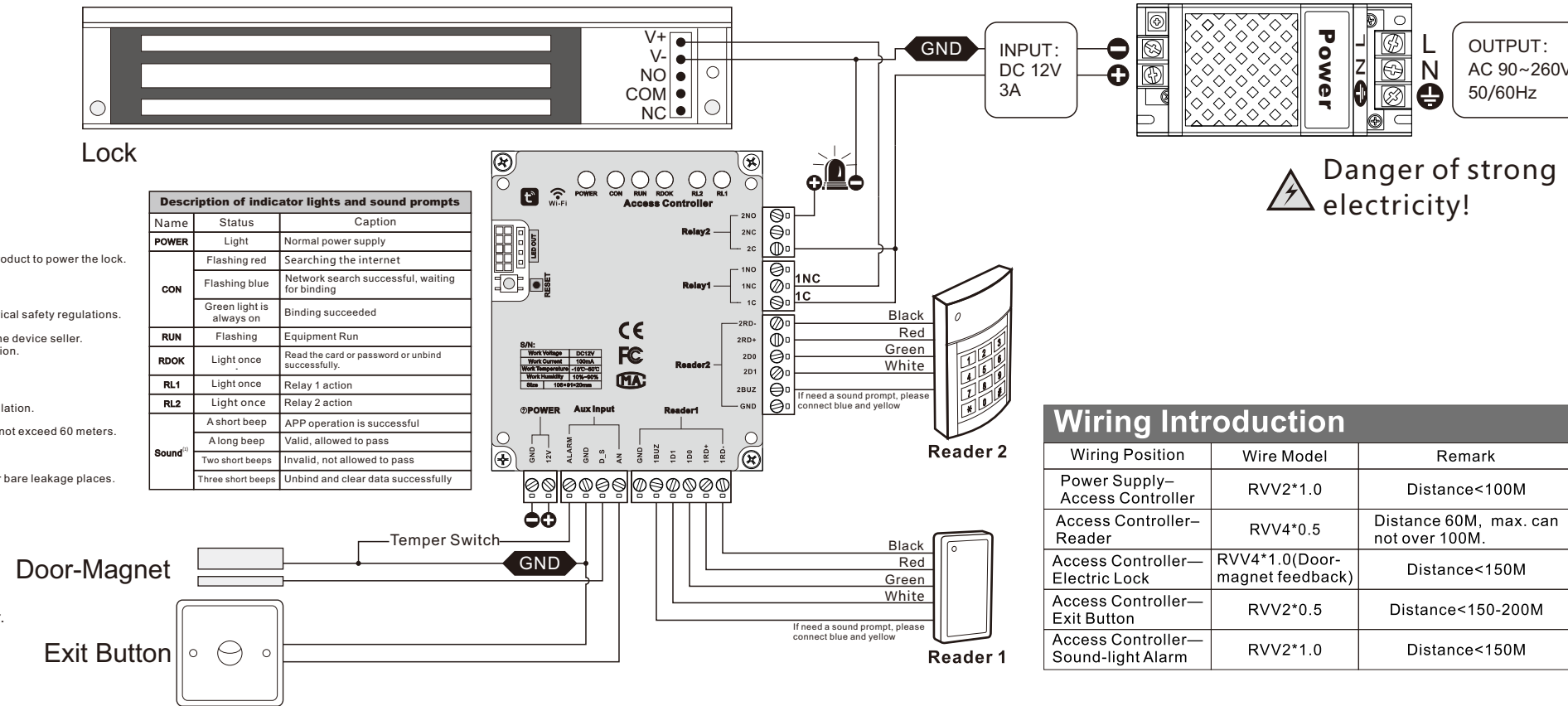

Danger of strong electricity!

Wiring Introduction

Wiring Position	Wire Model	Remark
Power Supply—Access Controller	RVV2*1.0	Distance<100M
Access Controller—Reader	RVV4*0.5	Distance 60M, max. can not over 100M.
Access Controller—Electric Lock	RVV4*1.0(Door-magnet feedback)	Distance<150M
Access Controller—Exit Button	RVV2*0.5	Distance<150-200M
Access Controller—Sound-light Alarm	RVV2*1.0	Distance<150M

6 Add Device

- 1 Click the icon in the lower left corner of the screen to enter "Home".
- 2 Users can manually add devices in these two places on the "Home" page.

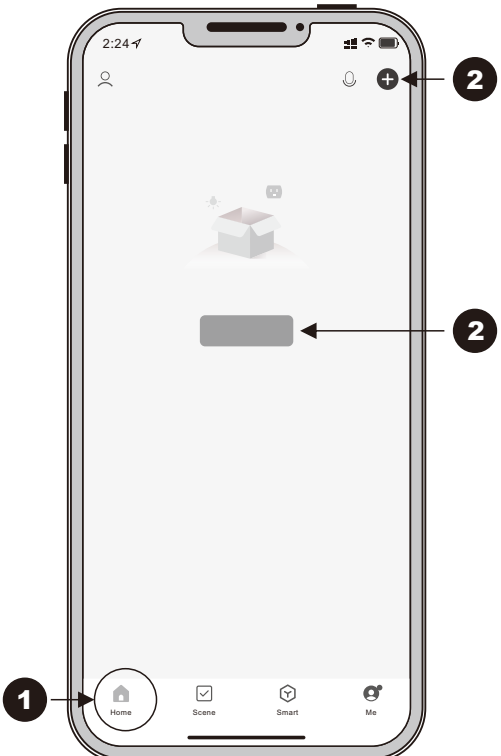

- 3 When the CON light of the device is flashing blue, the APP will automatically search for the device.

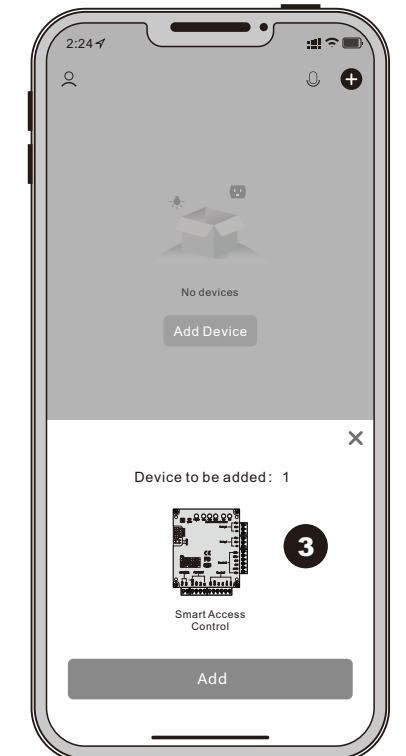

- 4 Select the WIFI that will be used. Note: The WIFI used must be the same as the WIFI used by the mobile phone.
- 5 Fill in the WIFI login password.

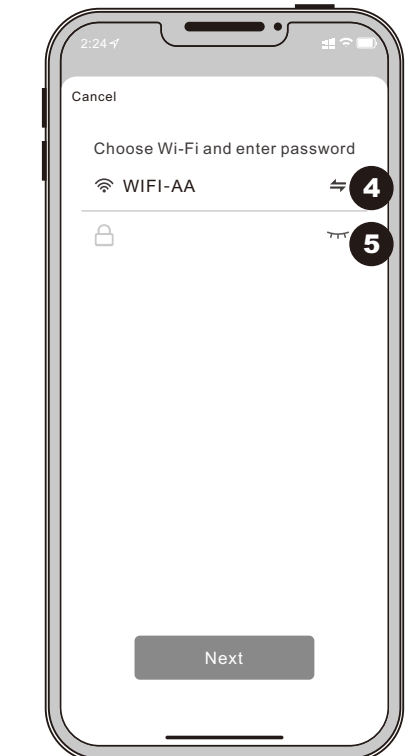

- 6 Log in to WIFI and wait for binding.

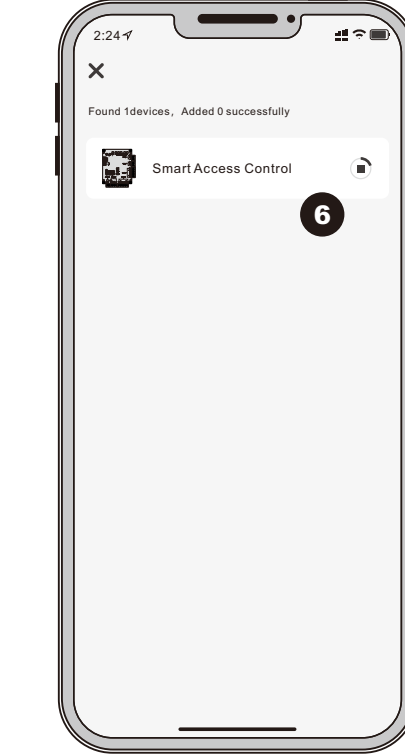

- 7 Binding succeeded.

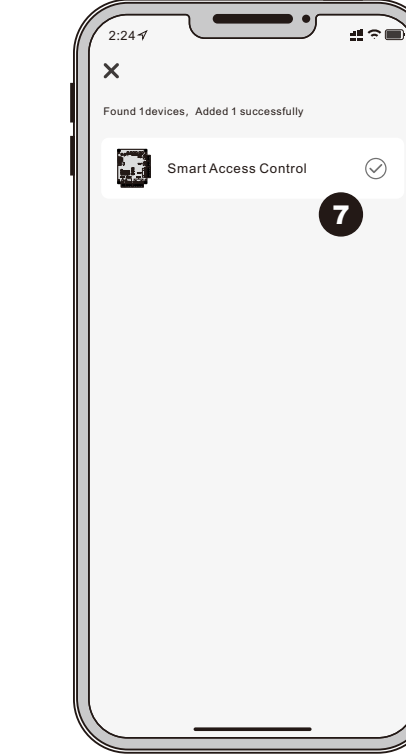

- 8 Finish adding.
- 9 A good name for the device can be better managed.

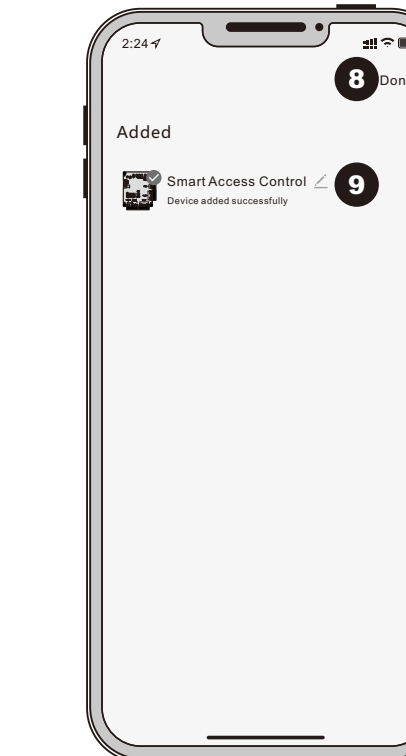

7 Remove device

- 1 Click the device in the device list to enter the "A" interface. Long press the device to enter the "B" interface.
- 2 "Remove device" in this interface is to delete the device from the device list and no longer control and use it. But the device has not been unbound. Cannot be bound by other users.
- 3 Click the Device Information button in the upper right corner of this interface.
- 4 "Remove device" in this interface is to unbind, and the unbound device can be bound and used by other users. Please note the distinction.

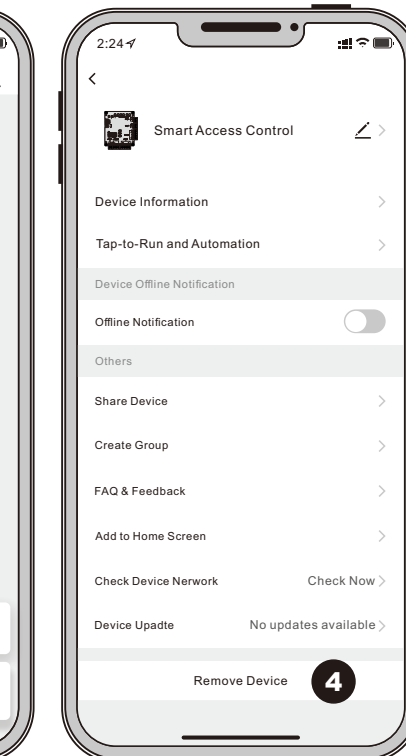
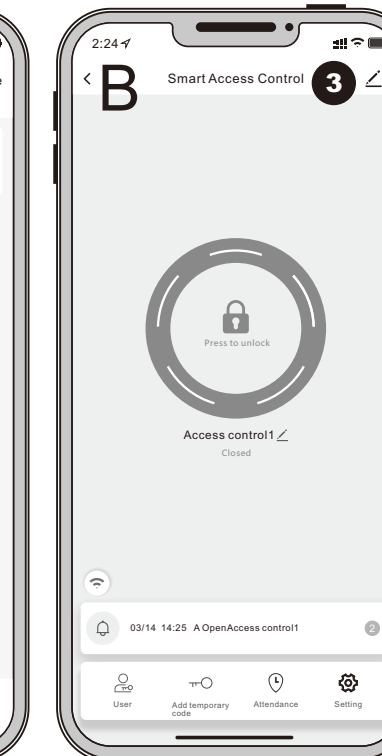
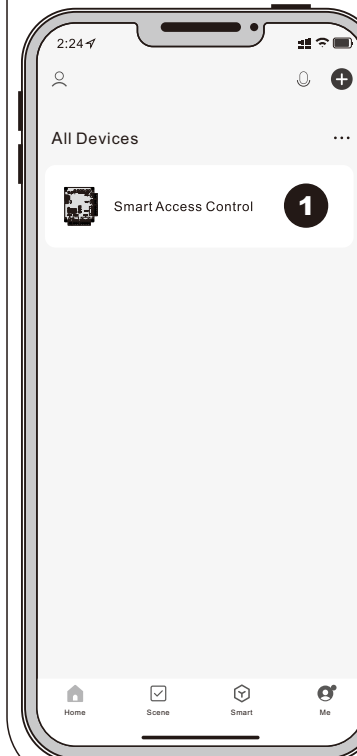

8 Setting Device Parameter

- 1 Click the "Setting" interface to set some parameters of the device.
- 2 When an exception occurs when the device is used for the first time, please turn on "Multiple Verification". Then use "Select unlock mode" in "Unlock by single mode" and then turn off "Multiple Verification". If the door cannot be closed automatically, please turn on "Automatic lock" and set the "Auto lock Time 3s".

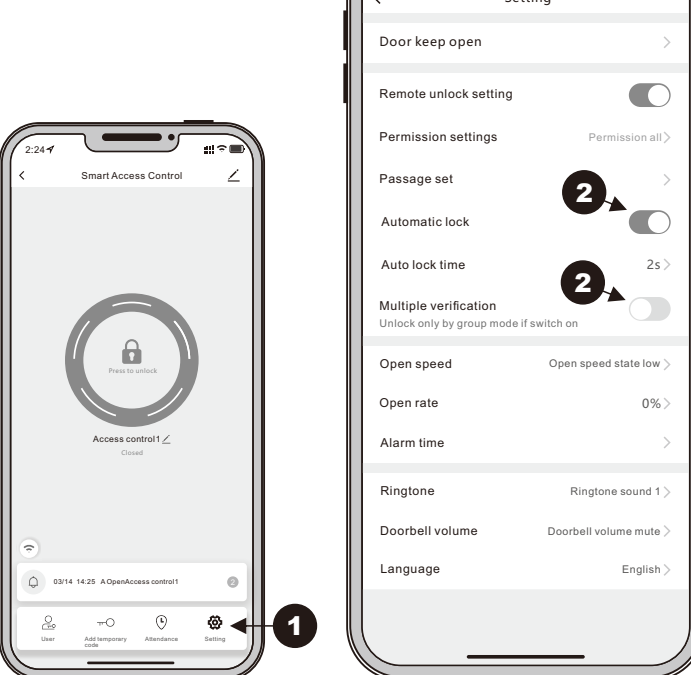

9 Remote control

- 1 Click the circular icon to open the door remotely. The device needs to match the key when using it for the first time. If it fails, please try again.

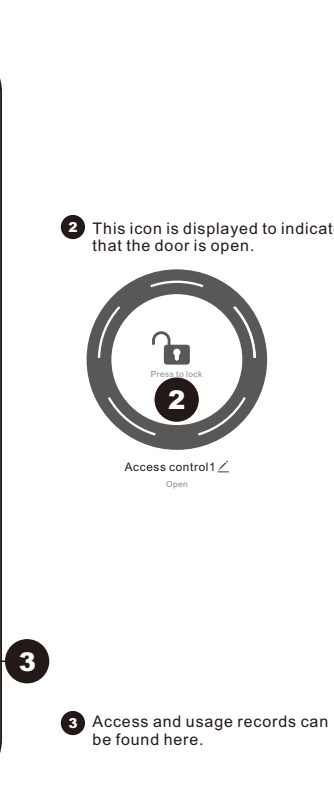
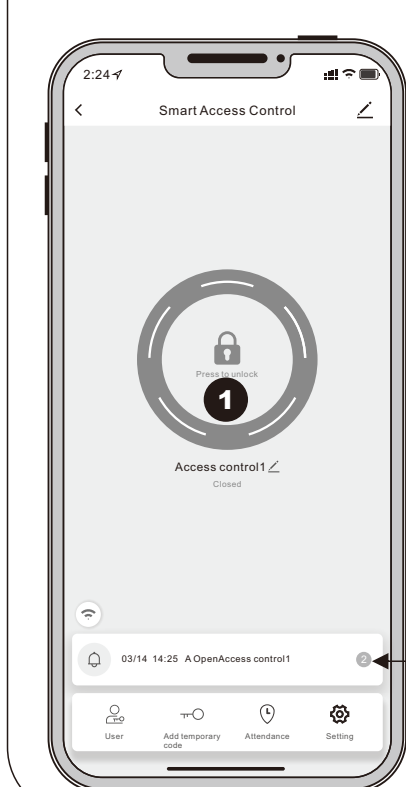

10 Add User & Card

- 1 Click the "User" button on the device interface to enter the personnel management interface.
- 2 Click the "+" button to add a new person.
- 3 Enter the basic information of the personnel, and go to "Next" after completion.
- 4 Click "Add Card" to add a card to the person.
- 5 With the card ready, click "Start Add".

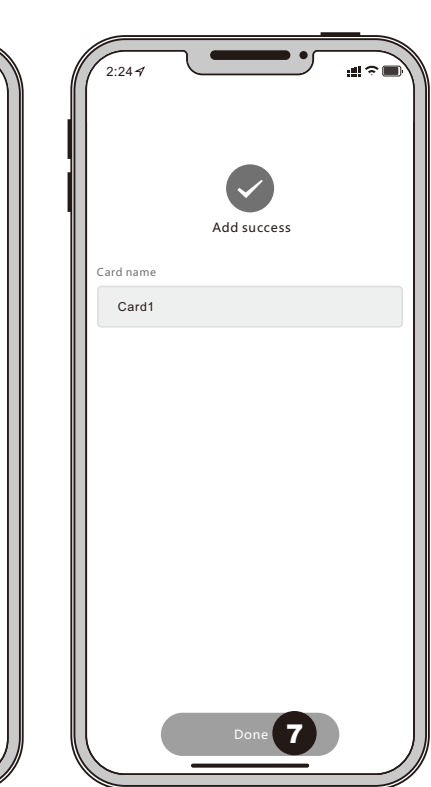
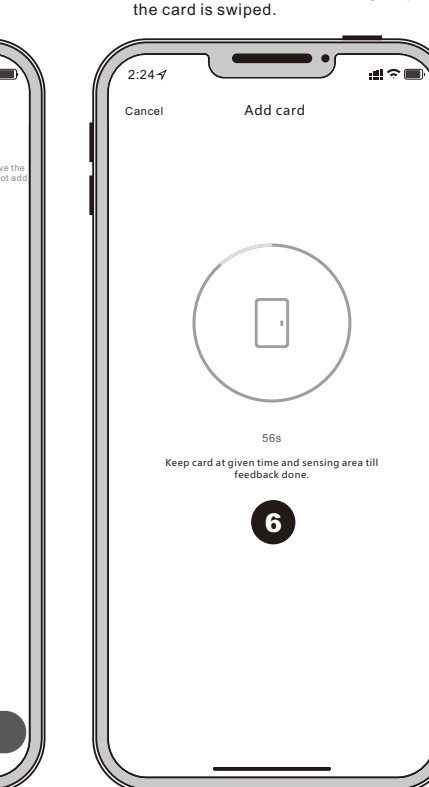
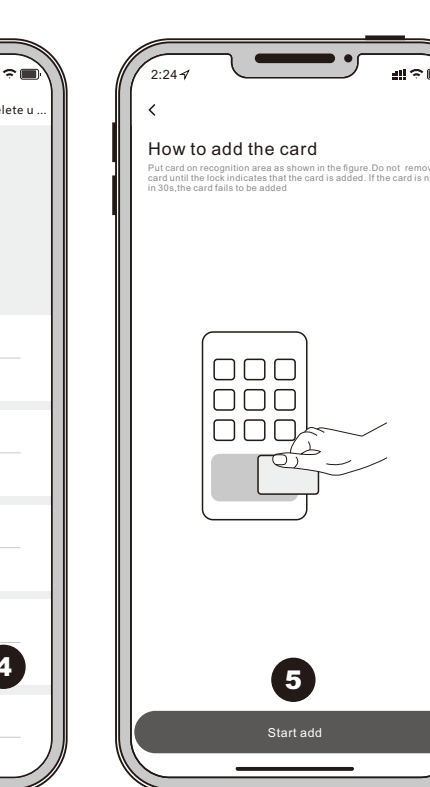
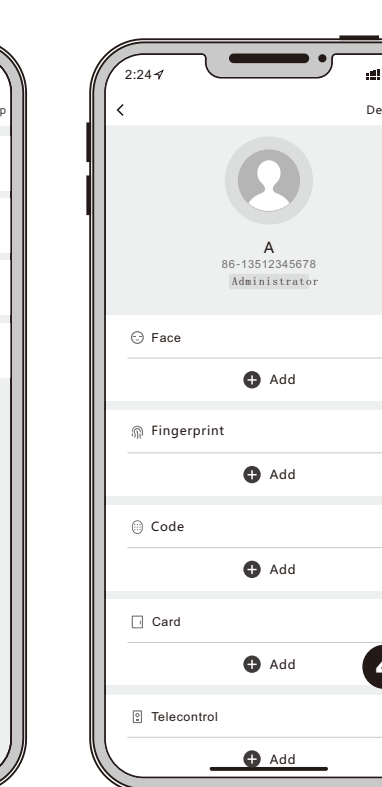
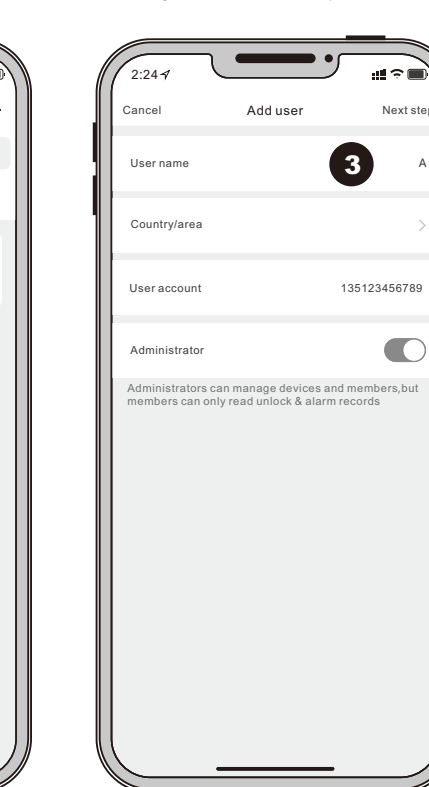
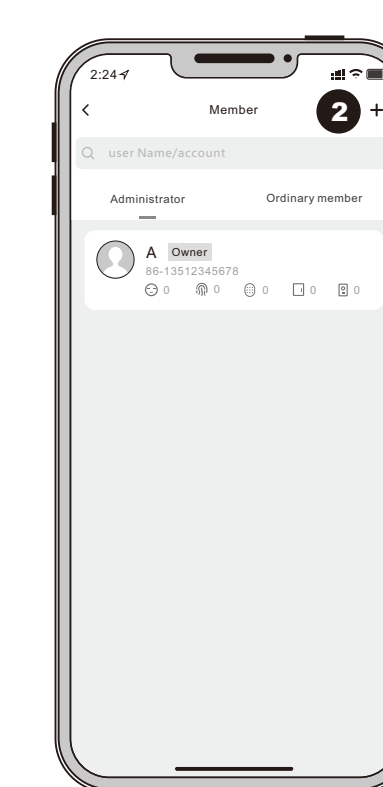
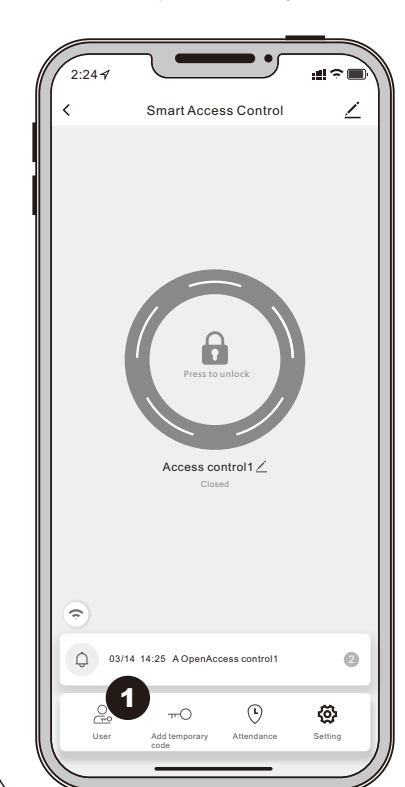

For other functions, please refer to Tuya APP. Please take Tuya APP as allow.